

REVISIONS

PART NO. ALNB

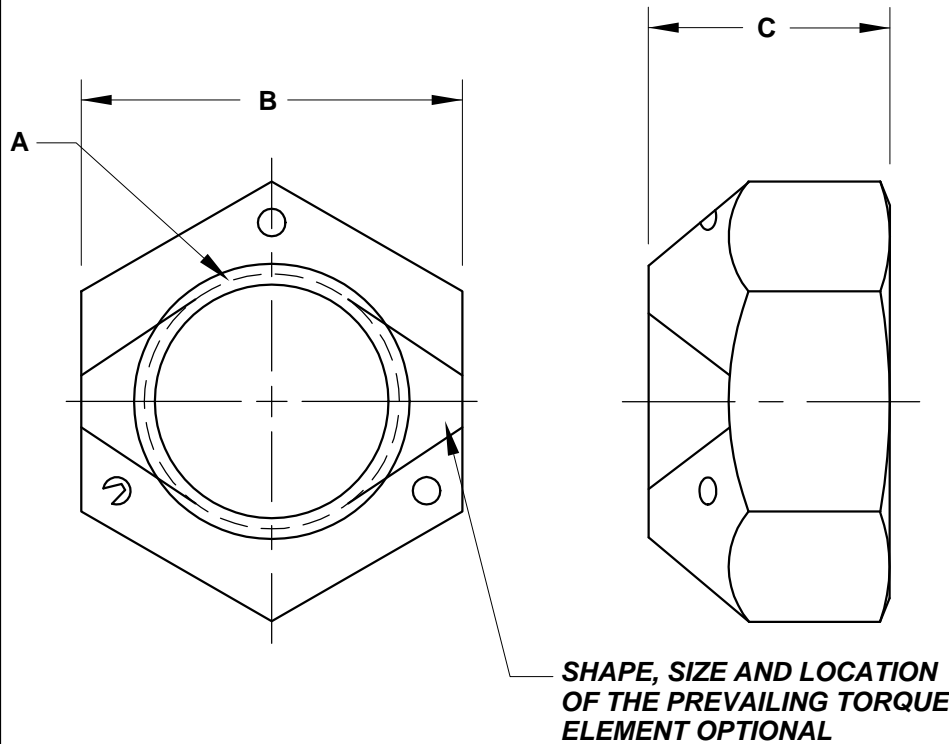

SIZE A	ZINC PLATED PART NUMBER	CADMIUM PLATED PART NUMBER	WIDTH ACROSS FLATS max / min B	THICKNESS max / min C
1/4-20	25CALNBZ	25CALNBC	.438 - .428	.288 - .212
1/4-28	25FALNBZ	25FALNBC		
5/16-18	31CALNBZ	31CALNBC	.502 - .489	.336 - .258
5/16-24	31FALNBZ	31FALNBC		
3/8-16	37CALNBZ	37CALNBC	.5645 - .551	.415 - .320
3/8-24	37FALNBZ	37FALNBC		
7/16-14	43CALNBZ	43CALNBC	.6895 - .675	.463 - .365
7/16-20	43FALNBZ	43FALNBC		
1/2-13	50CALNBZ	50CALNBC	.752 - .736	.573 - .427
1/2-20	50FALNBZ	50FALNBC		
9/16-12	56CALNBZ	56CALNBC	.877 - .861	.621 - .473
9/16-18	56FALNBZ	56FALNBC		
5/8-11	62CALNBZ	62CALNBC	.9395 - .922	.731 - .535
5/8-18	62FALNBZ	62FALNBC		
3/4-10	75CALNBZ	75CALNBC	1.127 - 1.088	.827 - .617
3/4-16	75FALNBZ	75FALNBC		
7/8-9	87CALNBZ	87CALNBC	1.3145 - 1.269	.922 - .724
7/8-14	87FALNBZ	87FALNBC		
1-8	100CALNBZ	100CALNBC	1.502 - 1.450	1.018 - .831
1-14	100FALNBZ	100FALNBC		

NOTES

MATL.: STEEL

APPROVAL

QC VC 10-10-05

UNLESS OTHERWISE INDICATED, DIMENSIONAL, MECHANICAL AND PERFORMANCE REQUIREMENTS PER IFI 100/107

**AUTOMATION LOCKNUTS
GRADE B**



DATE	DRAWN BY	SCALE	UNITS	DWG. TYPE	REV.
10-7-05	MP	NONE	INCH	S	0