

REVISIONS

PART NO. FTLAC

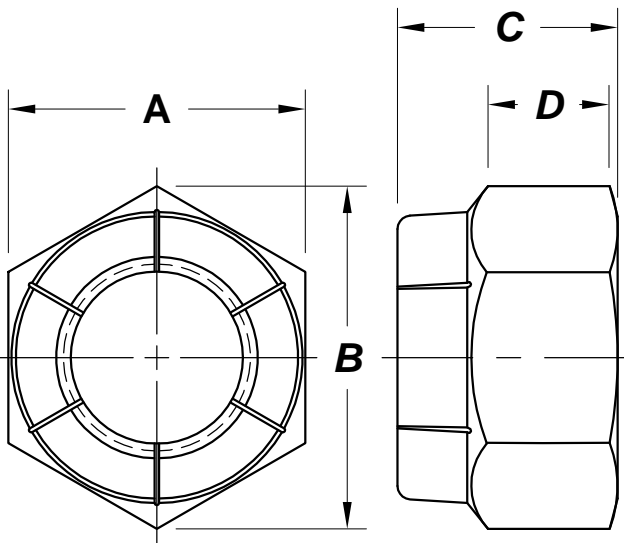

PART NUMBER	SIZE	WIDTH ACROSS FLATS	WIDTH ACROSS CORNERS	HEIGHT MAX.	WRENCH HEIGHT	AXIAL STRENGTH
		A(max-min)	B(ref.)	C(max.)	D(min.)	lbs (min.)
6CFTLAC	6-32 UNJC-3B	.313 - .305	.339	.180	.075	1620
8CFTLAC	8-32 UNJC-3B	.345 - .336	.374	.243	.105	2510
10CFTLAC	10-24 UNJC-3B	.376 - .367	.410	.243	.085	3120
10FFTLAC	10-32 UNJF-3B	.376 - .367	.410	.243	.085	3590
25CFTLAC	1/4-20 UNC-2B	.439 - .430	.482	.290	.122	5730
25FFTLAC	1/4-28 UNJF-3B	.439 - .430	.482	.320	.135	6550
31CFTLAC	5/16-18 UNC-2B	.502 - .492	.552	.353	.150	9600
31FFTLAC	5/16-24 UNJF-3B	.502 - .492	.552	.353	.150	9950
37CFTLAC	3/8-16 UNC-2B	.564 - .553	.622	.462	.210	13800
37FFTLAC	3/8-24 UNJF-3B	.564 - .553	.622	.462	.210	13500
50CFTLAC	1/2-13 UNC-2B	.752 - .741	.837	.602	.285	22000
50FFTLAC	1/2-20 UNJF-3B	.752 - .741	.837	.602	.285	23800
62CFTLAC	5/8-11 UNC-2B	.940 - .928	1.051	.759	.410	34000
62FFTLAC	5/8-18 UNJF-3B	.940 - .928	1.051	.759	.410	38400

NOTES

MATL.: STEEL PREVALING TORQUE PER NASM 25027
 FINISH: CAD

APPROVAL

QC VC 8-10-04

FLEX-TYPE LOCKNUT



DATE	DRAWN BY	SCALE	UNITS	DWG. TYPE	REV.
8-6-04	MP	NONE	INCH	S	0