

REVISIONS

PART NO. RFCF

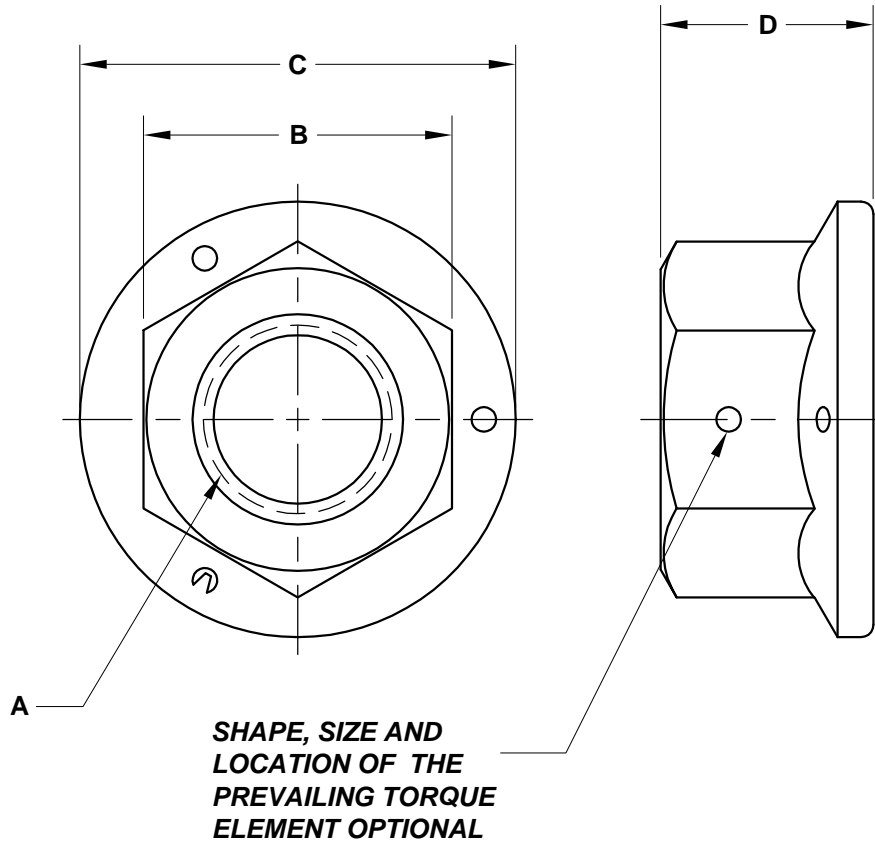

SIZE A	ZINC PLATED PART NUMBER	WIDTH ACROSS FLATS B	FLANGE DIAMETER C	NUT THICKNESS D
1/4-20	25CRFCFZ	.4385 - .428	.560 MAX.	.300 MAX.
1/4-28	25FRFCFZ			
5/16-18	31CRFCFZ	.502 - .489	.680 MAX.	.365 MAX.
5/16-24	31FRFCFZ			
3/8-16	37CRFCFZ	.5645 - .551	.810 MAX.	.425 MAX.
3/8-24	37FRFCFZ			
7/16-14	43CRFCFZ	.6895 - .675	.930 MAX.	.495 MAX.
7/16-20	43FRFCFZ			
1/2-13	50CRFCFZ	.752 - .736	1.070 MAX.	.555 MAX.
1/2-20	50FRFCFZ			
9/16-12	56CRFCFZ	.877 - .861	1.190 MAX.	.625 MAX.
9/16-18	56FRFCFZ			
5/8-11	62CRFCFZ	.9395 - .922	1.330 MAX.	.690 MAX.
5/8-18	62FRFCFZ			
3/4-10	75CRFCFZ	1.127 - 1.088	1.585 MAX.	.825 MAX.
3/4-16	75FRFCFZ			

NOTES

MATL.: STEEL

APPROVAL

QC VC 10-14-05

UNLESS OTHERWISE INDICATED, DIMENSIONAL, MECHANICAL AND PERFORMANCE REQUIREMENTS PER IFI 100/107

**FLANGE NUT CENTERLOCK
GRADE F**



DATE	DRAWN BY	SCALE	UNITS	DWG. TYPE	REV.
10-11-05	MP	NONE	INCH	S	0